

OWL SURFACE OVERSHOT | BWL

EXPLODED VIEW | BWL

| ASSY. | DESCRIPTION | PART NUMBER | WEIGHT | |
|-------|-------------------|-------------|--------|------|
| | | | lb | kg |
| A | Overshot assy | 11S-B10-021 | 22.7 | 12.7 |
| B | Cable swivel assy | 11S-10-022 | 0.69 | 0.31 |

| | DESCRIPTION | PART NUMBER |
|---|--|-------------|
| B | Wire rope thimble (3/16") | 11S-10-001 |
| | Eye bolt | 11S-10-002 |
| | Cable swivel collar | 11S-10-003 |
| | Needle thrust bearing | 11S-10-004 |
| | Nut | 11S-10-005 |
| | Cotter pin (3/32" x 3/4") | 11S-10-006 |
| A | Grease fitting | 10S-10-31G |
| | Cable swivel body | 11S-B10-008 |
| | Jar tube | 11S-B10-009 |
| | Self lock nut | 11S-B10-010 |
| | Jar staff | 11S-B10-011 |
| | Locking sleeve | 11S-B10-012 |
| | Coiled spring pin (7/32" x 1-1/4") (2) | 11S-B10-013 |
| | Machine screw | 11S-10-014 |
| | Lifting dog pivot pin | 11S-B10-015 |
| | Slotted spring pin 3/16" X 1-3/8" | 11S-B10-016 |
| | Overshot head | 11S-B10-017 |
| | Lifting dog spring | 11S-10-019 |
| | Lifting dog (2) | 11S-B10-020 |

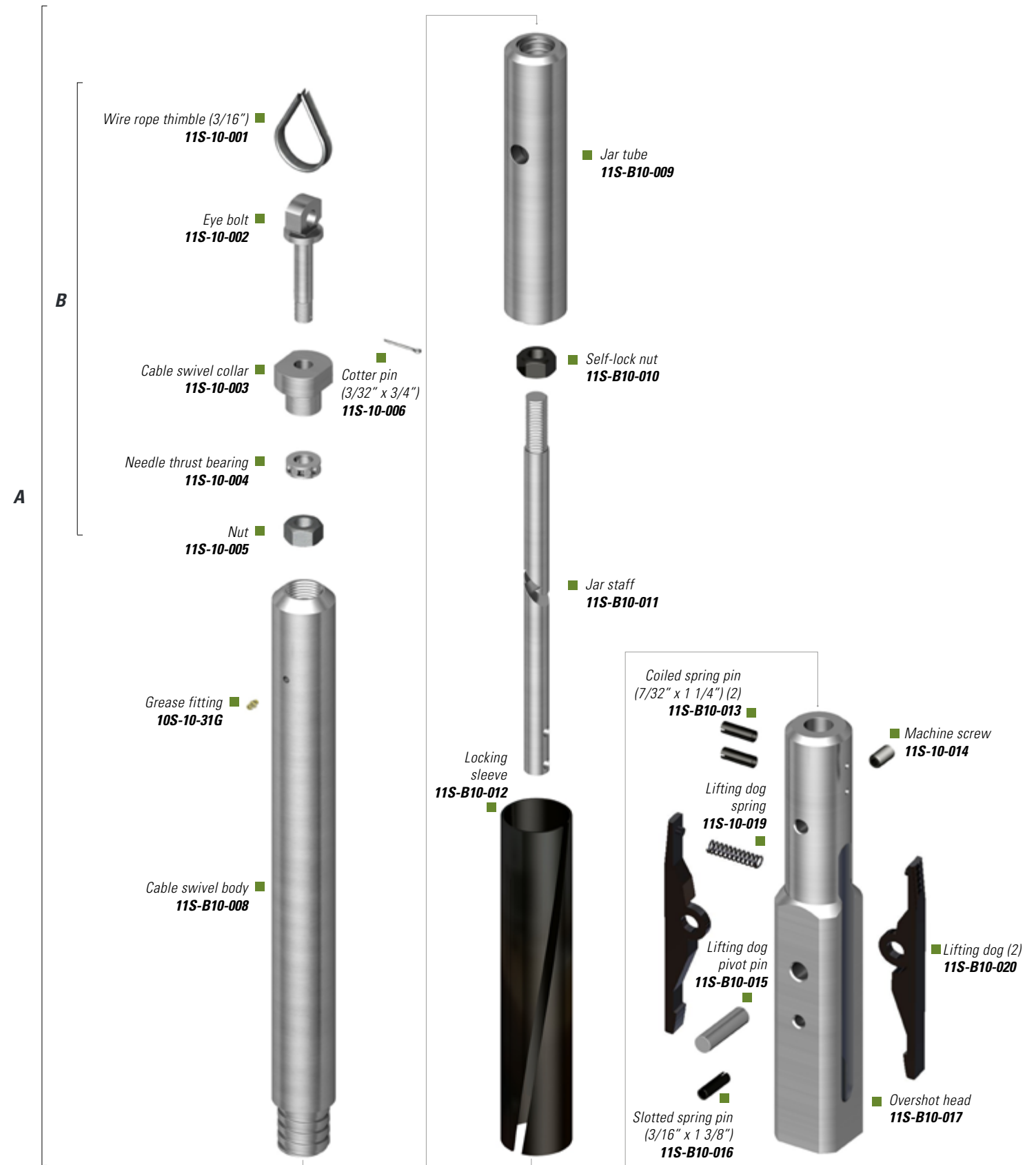

LOCKING OVERSHOT SURFACE | BWL

LOCKING OVERSHOT SURFACE | BWL

| ASSY. | DESCRIPTION | PART NUMBER | WEIGHT | |
|-------|---------------------------|---------------|--------|------|
| | | | lb | kg |
| A | Locking overshot assy BWL | 11S-B10-021EL | 21.91 | 9.94 |
| B | Cable swivel assy BWL | 11S-10-022 | 0.56 | 0.26 |

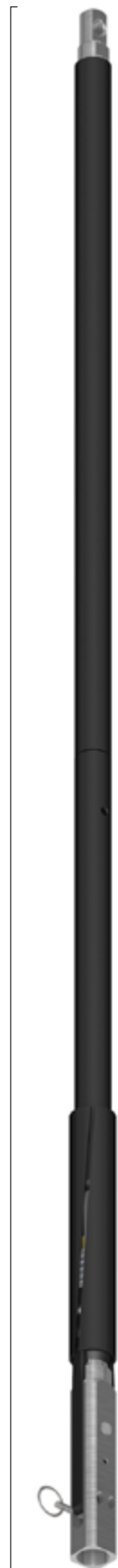

| DESCRIPTION | PART NUMBER |
|----------------------------------|---------------|
| Bolt, cable swivel eye | 11S-10-002 |
| Cable swivel collar | 11S-10-003 |
| Thrust bearing | 11S-10-004 |
| Castle nut | 11S-10-005 |
| Cotter pin | 11S-10-006 |
| Grease fitting | 10S-10-31G |
| Cable swivel body | 11S-B10-008 |
| Jar staff | 11S-B10-011 |
| Jar tube | 11S-B10-009 |
| Hex nut 9/16" UNC | 11S-B10-010EL |
| Washer, Nord-Lock | 11S-B10-011EL |
| Cap, locking overshot | 11S-B10-012EL |
| Spring, locking overshot | 11S-B10-013EL |
| Sleeve, locking overshot | 11S-B10-014EL |
| Compression spring | 11S-B10-015EL |
| Ball 11/32" (2) | 11S-10-025 |
| Head, locking overshot | 11S-B10-017 |
| Compression spring | 11S-10-019 |
| Lifting dog (2) | 11S-B10-020 |
| Plain pin 1/2" X 1-1/2" | 11S-B10-015 |
| Spring pin 3/16" X 1-3/8" | 11S-B10-016 |
| Locking pin | 11S-10-023EL |
| Set screw, 3/8" UNF X 3/4" NYLOK | 10A-056EL |
| Locking sleeve | 10S-B10-012 |

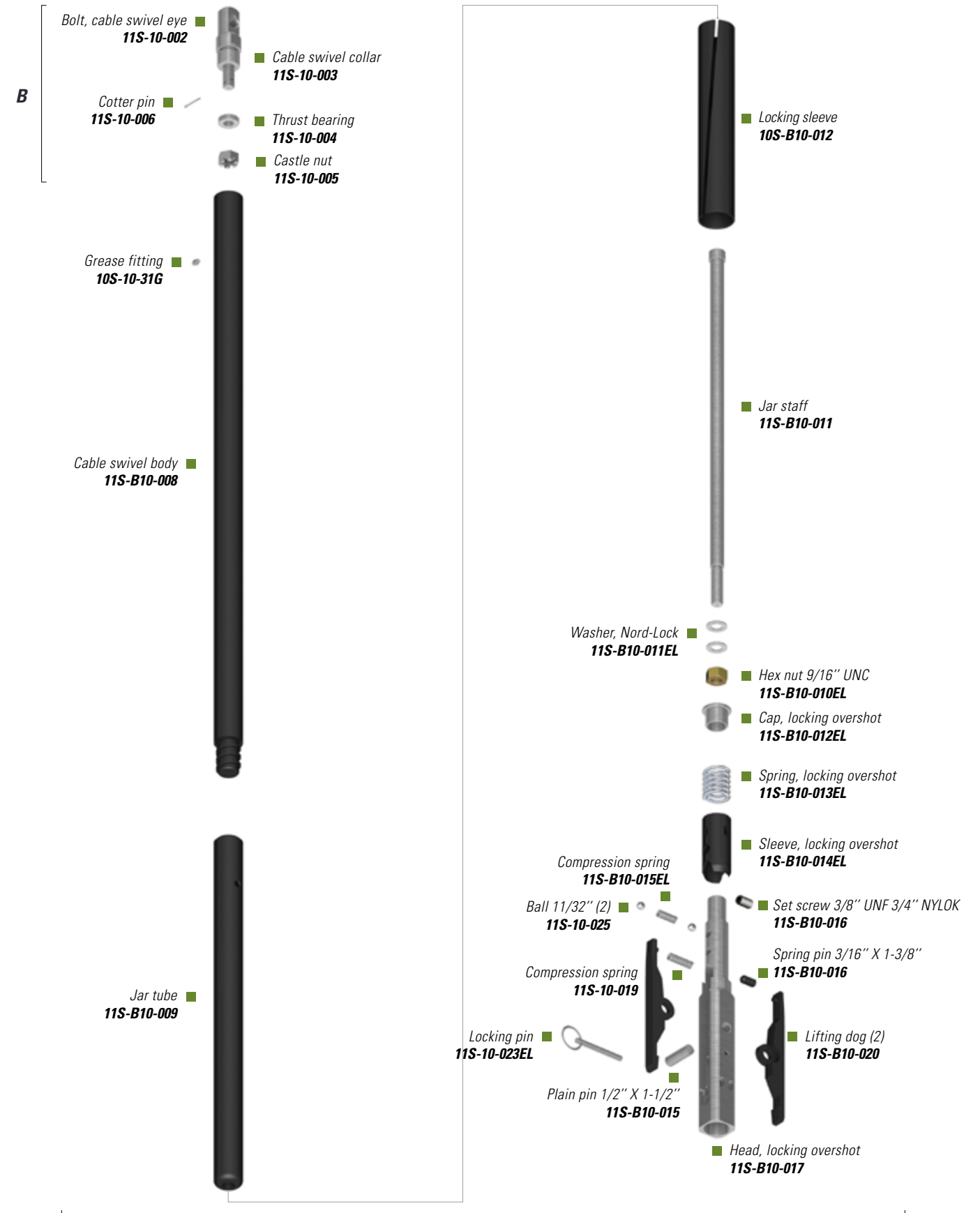

OWL SURFACE OVERSHOT | NWL

EXPLODED VIEW | NWL

| ASSY. | DESCRIPTION | PART NUMBER | WEIGHT | |
|-------|-------------------|-------------|--------|------|
| | | | lb | kg |
| A | Overshot assy | 11S-N10-021 | 35.4 | 16 |
| B | Cable swivel assy | 11S-10-022 | 0.69 | 0.31 |

| | DESCRIPTION | PART NUMBER |
|---|---------------------------------------|-------------|
| B | Wire rope thimble (3/16") | 11S-10-001 |
| | Eye bolt | 11S-10-002 |
| | Cable swivel collar | 11S-10-003 |
| | Needle thrust bearing | 11S-10-004 |
| | Nut | 11S-10-005 |
| | Cotter pin (3/32" x 3/4") | 11S-10-006 |
| A | Grease fitting | 10S-10-31G |
| | Cable swivel body | 11S-10-008 |
| | Jar tube | 11S-10-009 |
| | Self lock nut | 11S-10-010 |
| | Jar staff | 11S-10-011 |
| | Locking sleeve | 11S-10-012 |
| | Coiled spring pin (1/4" x 1-1/2") (2) | 11S-10-013 |
| | Machine screw | 11S-10-014 |
| | Lifting dog pivot pin | 11S-N10-015 |
| | Slotted spring pin 1/4" X 1-3/4" | 11S-10-016 |
| | Overshot head | 11S-N10-017 |
| | Lifting dog spring | 11S-10-019 |
| | Lifting dog (2) | 11S-10-020 |



OWL SURFACE OVERSHOT | HWL

EXPLODED VIEW | HWL

| ASSY. | DESCRIPTION | PART NUMBER | WEIGHT | |
|-------|-------------------|-------------|--------|------|
| | | | lb | kg |
| A | Overshot Assy | 11S-H10-021 | 37.3 | 17 |
| B | Cable swivel assy | 11S-10-022 | 0.69 | 0.31 |

| DESCRIPTION | PART NUMBER |
|---------------------------------------|-------------|
| Wire rope thimble (3/16") | 11S-10-001 |
| Eye bolt | 11S-10-002 |
| Cable swivel collar | 11S-10-003 |
| Needle thrust bearing | 11S-10-004 |
| Nut | 11S-10-005 |
| Cotter pin (3/32" x 3/4") | 11S-10-006 |
| Grease fitting | 10S-10-31G |
| Cable swivel body | 11S-10-008 |
| Jar tube | 11S-10-009 |
| Self lock nut | 11S-10-010 |
| Jar staff | 11S-10-011 |
| Locking sleeve | 11S-10-012 |
| Coiled spring pin (1/4" x 1-1/2") (2) | 11S-10-013 |
| Machine screw | 11S-10-014 |
| Lifting dog pivot pin | 11S-H10-015 |
| Slotted spring pin 1/4" X 1-3/4" | 11S-10-016 |
| Overshot head | 11S-H10-017 |
| Sleeve adaptor | 11S-H10-018 |
| Lifting dog spring | 11S-10-019 |
| Lifting dog (2) | 11S-10-020 |

